

Frank Harris & Co.



Forum Magnum Square, SE1

£625 Per week

Modern two double bedroom, two bathroom apartment (approx 859 sq ft) in the sought after East Block of the prestigious County Hall landmark development on the South Bank.

The apartment is close to the London Eye and is a short walk from Waterloo Station.

- Furnished • Spacious • Good transport links •
- 24 Hour concierge • Gym, Pool and Sauna • Available now. •

Frank Harris & Co.

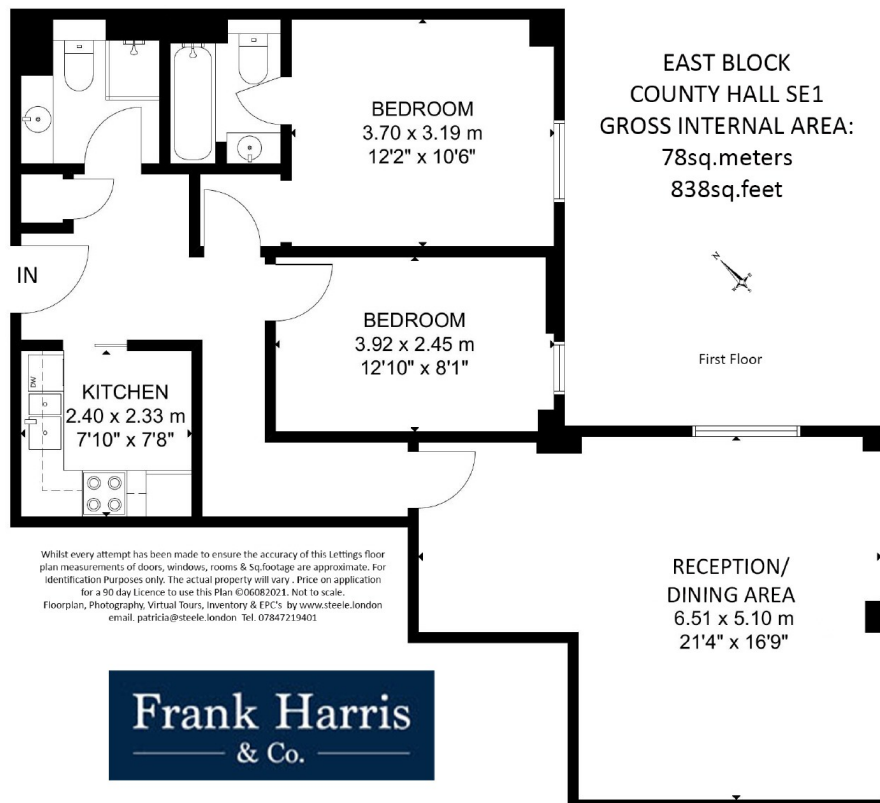

Frank Harris & Co. Southbank and Waterloo
123 Stamford Street, London,
SE1 9NN
020 7590 7100
southbank@frankharris.co.uk

Energy Rating: . We aim to make our particulars both accurate and reliable. However they are not guaranteed; nor do they form part of an offer or contract. If you require clarification on any points then please contact us, especially if you're traveling some distance to view. Please note that appliances and heating systems have not been tested and therefore no warranties can be given as to their good working order.