



## **Vicars Bridge Close, HA0**

**£330,000**

A two bedroom flat in a quiet and residential purpose-built development. The flat has two double bedrooms, generous amount of fitted wardrobe storage throughout and an allocated off-street parking space.

Half a mile from Alperton station (Piccadilly line) and half mile from Hanger Lane station (Central line). The North Circular and A40 are nearby.

- Allocated Parking Space • Top Floor • Separate Kitchen •
- Quiet Location • Purpose-Built • Ample Storage Space •

## Second Floor

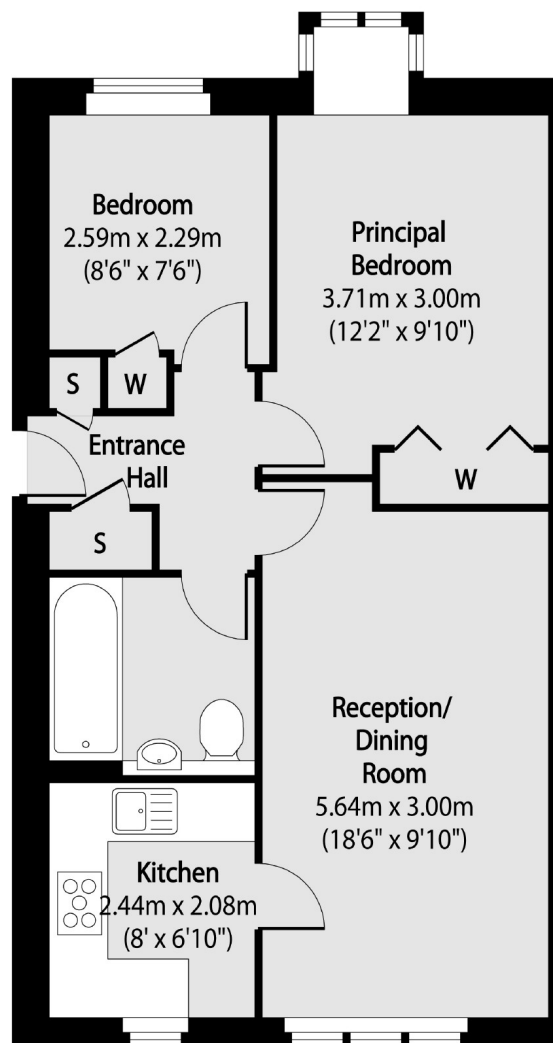

Total area (approx): 49.70 sq m (535 sq. ft)

Robertson Smith & Kempson Ealing Sales  
1 The Broadway, London,  
W5 2NT  
020 8840 7677  
[ealingsales@robertsonsmithandkempson.co.uk](mailto:ealingsales@robertsonsmithandkempson.co.uk)

Energy Rating: C. We aim to make our particulars both accurate and reliable. However they are not guaranteed; nor do they form part of an offer or contract. If you require clarification on any points then please contact us, especially if you're traveling some distance to view. Please note that appliances and heating systems have not been tested and therefore no warranties can be given as to their good working order.