



Friars Stile Road, Richmond

£POA Leasehold



Major
Son & Phipps



A large and rarely available second and third floor apartment and loft arranged over three floors in the heart of the Village Conservation Area, on Richmond Hill. This building of Townscape Merit reveals a pretty stepped gable facade with a light triple aspect interior and high ceilings, period features, large windows and spectacular sunsets and far reaching views from the three elevations. An abundant amount of built-in-storage. High specification throughout including, a new boiler, cooker and washing machine. An integral study/office. A jacuzzi bath completes the bathroom. The original fireplace compliments the living area. A huge principal bedroom is in excess of 300 square feet. A unique and versatile property with scope to develop the loft (included in the sale) and enlarge/extend even further [STPP].

Amenities

Well sited for all local amenities including, Richmond Park, Terrace Gardens, Richmond Riverside, Town Centre, restaurants, bars, cinema and shopping.

Travel

A local bus service runs moments from Friars Stile Road. Within walking distance is Richmond Train station, providing access to tube and SW trains direct to Waterloo and onwards. Access to Heathrow airport

Schools

Outstanding schools also within walking distance including, The Vineyard, The Old Vicarage, The German School and Kings House School.

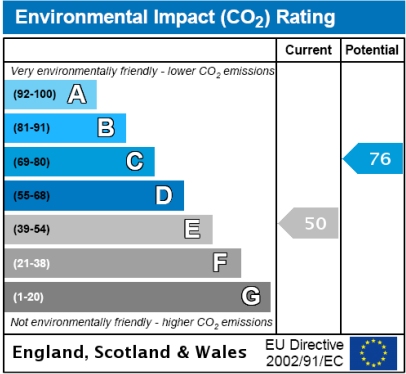
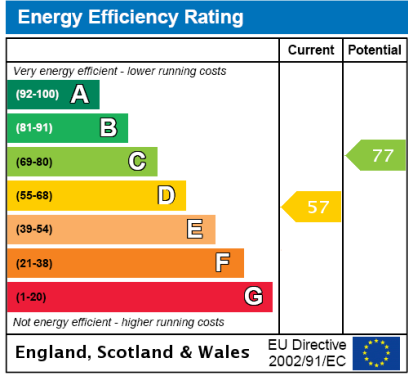

Contact us:
Tel 020 8940 2233
majorsonphipps@btinternet.com
www.majorsonphipps.com

Major Son and Phipps
Dome Buildings
5a The Square
Richmond
Surrey
TW9 1DX



Major

Son & Phipps

Dome Buildings

Estate Agency

Friars Stile Road

Second & Third Floor Approx. Gross Internal Floor Area
114.83 Sq M - 1236 Sq Ft
 Fourth Floor (Not included in measurements)

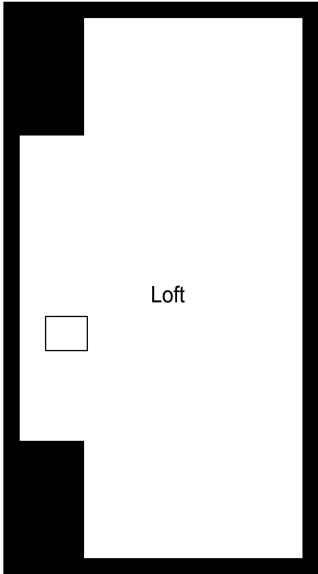

Fourth Floor
(Loft included in sale)

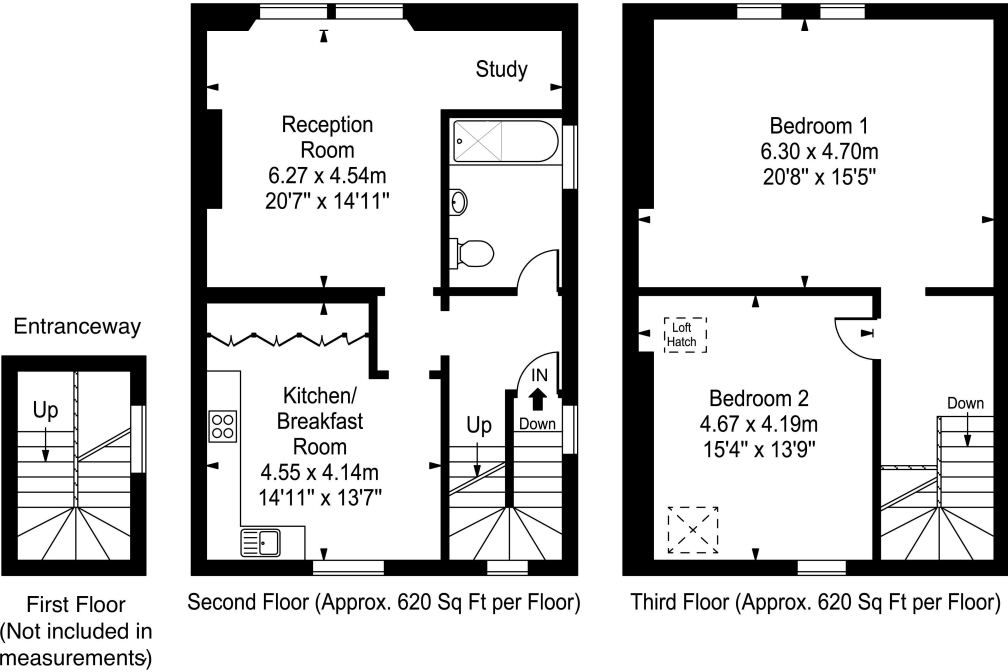

Every attempt is made to assure accuracy, however measurements are approximate and for illustrative purposes only. Not to scale.



Contact us:

Tel 020 8940 2233

majorsonphipps@btinternet.com

www.majorsonphipps.com

Major Son and Phipps

Dome Buildings

5a The Square

Richmond

Surrey

TW9 1DX



Major Son & Phipps give notice to anyone reading these particulars that: (i) these particulars do not constitute part of an offer or contract; (ii) these particulars and any pictures or plans represent the opinion of the author and are given in good faith for guidance only and must not be construed as statements of fact; (iii) nothing in the particulars shall be deemed a statement that the property is in good condition otherwise; we have not carried out a structural survey of the property and have not tested the services, appliances or specified fittings.



Major
Son & Phipps