



**Shirehampton - £165,000**

**1 bed apartment**

**26 Springfield Avenue, BS11 9TN**





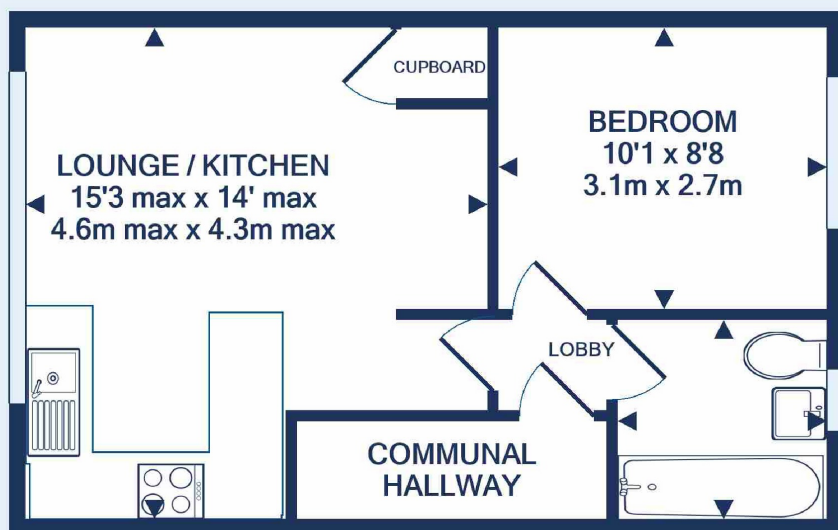

Made with Metropix ©2021



This first floor apartment is located on a popular road in the village - close to th High Street with its shops, cafes and amenities and a short walk to the local transport links providing easy access to the city centre.

There is an open plan lounge / kitchen which has a large window that allows plenty of natural light into this space.  
The kitchen has an integrated oven & hob and there is a useful storage cupboard in the lounge area.

The double bedroom is at the back of the flat and there is a bathroom with a white suite.

The flat has gas central heating, double glazing and is being sold with no onward chain.



### Shirehampton Office

14-16 High Street, Shirehampton, Bristol,  
BS11 0DP

Call: 0117 9380611

Mail:

Search: [oceanhome.co.uk](http://oceanhome.co.uk)

References to the Tenure of a Property are based on information supplied by the Seller. The Agent has not had sight of the title documents. Lease details, service ground rent (where applicable) are given as a guide only and should be checked and confirmed by your solicitor prior to exchange of contracts.