

ROKSTONE



Great Portland Street, Fitzrovia, W1W

A bright and spacious two double bedroom apartment situated in a purpose built block with caretaker in the heart of the West End.

The apartment comprises an entrance hallway, spacious open plan kitchen and reception, two double bedrooms with built in storage space and two bathrooms. Located within the highly sought after area of Fitzrovia filled with West End theatres, galleries, boutiques and cafes, the apartment is moments away from Regents Park with Great Portland Street and Oxford Circus tube station within walking distance with easy access to all corners of London including the City.

The property is available on a furnished basis for long let. This is a great opportunity to rent an apartment in one of London's premier postcodes.

Price £830 pw



Olivia McSweeney | Head of Lettings
D: 020 3219 5679 | M: 07584633058 | E: olivia@rokstone.com
5 Dorset Street, London, W1U 6QJ

ROKSTONE

Great Portland Street
 Approx. Gross Internal Area 798 Sq Ft - 74.14 Sq M

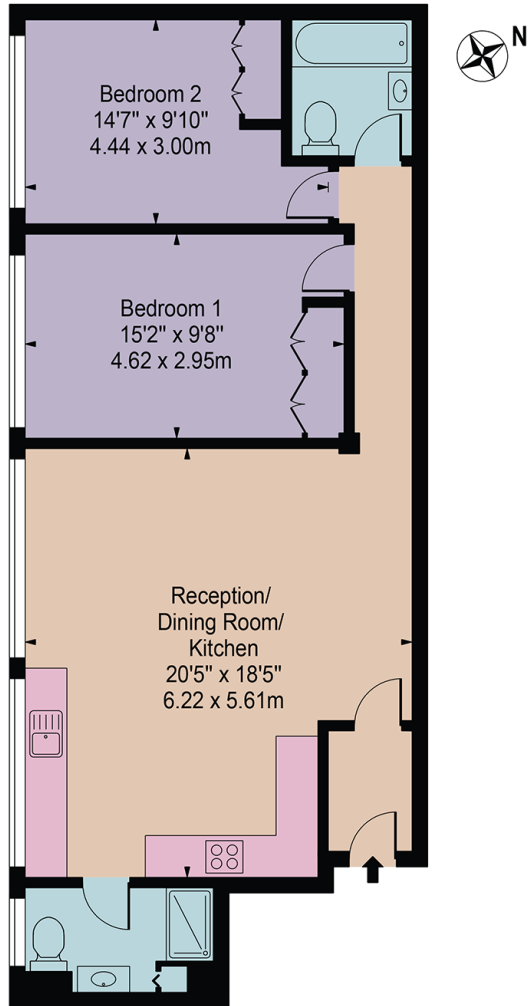

First Floor

For Illustration Purposes Only - Not To Scale

This floor plan should be used as a general outline for guidance only and does not constitute in whole or in part an offer or contract. Any intending purchaser or lessee should satisfy themselves by inspection, searches, enquiries and full survey as to the correctness of each statement. Any areas, measurements or distances quoted are approximate and should not be used to value a property or be the basis of any sale or let.

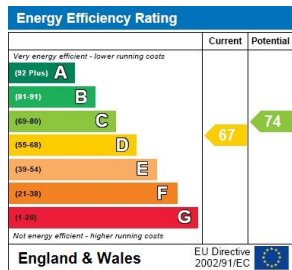

Olivia McSweeney | Head of Lettings
 D: 020 3219 5679 | M: 07584633058 | E: olivia@rokstone.com
 5 Dorset Street, London, W1U 6QJ