

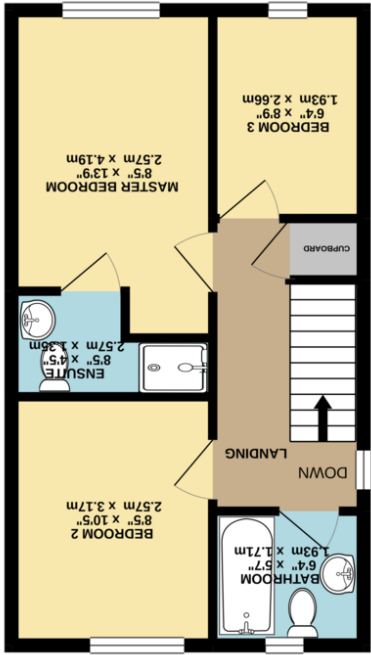

18 Woodlands Chase, Kimberworth Park, Rotherham, S61 3DQ

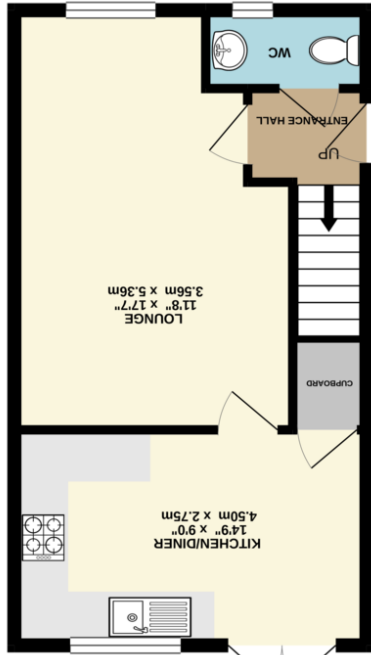

1ST FLOOR
393 sq.ft. (36.5 sq.m.) approx.



GROUND FLOOR
393 sq.ft. (36.5 sq.m.) approx.

While every attempt has been made to ensure the accuracy of the floorplan contained herein, measurements of doors, windows, rooms and other areas are approximate and no responsibility is taken for any omission or mis-statement. This plan is for illustrative purposes only and should be used as such by any prospective purchaser. The services, fixtures and appliances shown have not been tested and no guarantee as to their quality or efficiency can be given.

Bakewell
3 Royal Oak Place
Matlock Street
Bakewell DE45 1HD
T: 01629 700699
E: bakewell@elr.co.uk

Banner Cross
888 Ecclesall Road
Banner Cross
Sheffield S11 8TP
T: 01142 683388
E: bannercross@elr.co.uk

Dore
33 Townhead Road
Sheffield
S17 3GD
T: 0114 2362420
E: dore@elr.co.uk

Hathersage
Main Road, Hathersage
Hope Valley
Derbyshire S32 1BB
T: 01433 651888
E: peackdistrict@elr.co.uk

Rotherham
149 Bawtry Road
Wickersley
Rotherham S66 2BW
T: 01709 917676
E: wickersley@elr.co.uk

18 Woodlands Chase,

Kimberworth Park, S61 3DQ

Of particular appeal to the first time buyers or growing family alike & situated to the head of a cul de sac location, is this 3 bedroom end town house with off road parking to the front for 3/4 cars.

Enjoying the added benefit of a downstairs toilet, the property also enjoys gas central heating via the combination boiler which in turn is controlled via a 'Nest' thermostat. With a front facing living room & dining kitchen beyond which has a range of fitted units & houses the combination boiler.

To the first floor are 2 double bedrooms, a single & the main bedroom with en suite shower room.

To the rear is a lovely enclosed garden area with artificial grass, patio area & garden shed.

On nearby Roughwood Road are bus services to the town centre along with convenience store.

All in all a great little starter home.

- A 3 bedroom end terraced
- Situated to head of a cul de sac
- Front driveway for 3/4 cars
- Rear enclosed garden & Ground floor WC
- Rear dining kitchen with access to rear garden
- Just a few hundred yards from Roughwood Primary School
- Family bathroom in white suite with shower over bath
- En suite to Principal bedroom
- Great home for the first time buyers
- Viewing recommended

