

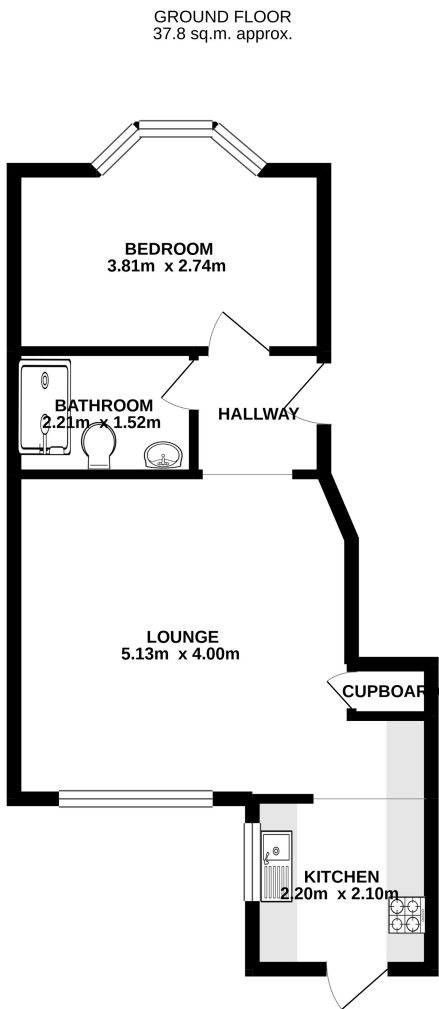

Chatham Place, BRIGHTON, BN1 3TP
£275,000

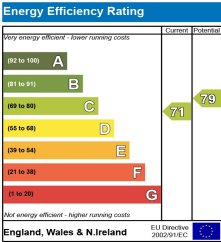

TOTAL FLOOR AREA : 37.8 sq.m. approx.
Whilst every attempt has been made to ensure the accuracy of the floorplan contained here, measurements of doors, windows, rooms and any other items are approximate and no responsibility is taken for any error, omission or mis-statement. This plan is for illustrative purposes only and should be used as such by any prospective purchaser. The services, systems and appliances shown have not been tested and no guarantee as to their operability or efficiency can be given.
Made with Metropix ©2021.



01273 555115
info@johnhoole.co.uk
johnhoole.co.uk
214 Dyke Road | Brighton | BN1 5AA

Agents note: All measurements are approximate and whilst every attempt has been made to ensure accuracy they are for general guidance only and must not be relied on. The fixture and fittings referred to have not been tested and therefore no guarantee can be given that they are in working order. Internal photographs are reproduced for general information and it must not be inferred that any item shown is included with the property.





John Hoole Estate Agents are very pleased to offer to the market this gem of a property in the heart of the popular area of Seven Dials, with its eclectic mix of eateries, boutiques and artisan bakeries. A stone's throw from Brighton city centre too, this lovely 1-bed ground floor flat will make an ideal first home or rental investment and for those looking for some outside space, its south-facing garden offers a good-sized lawned area and scope to use your own green-fingered flair. Internally, the accommodation comprises of a well-proportioned living/dining room with very high ceilings and a large sash window, steps leading down to the kitchen and through to the garden, a double bedroom, shower room and hall area.

Located on Chatham Place, commuters will find that their walk to Brighton station takes less than 10 minutes and regular bus services through Seven Dials offer routes across Brighton and beyond. We highly recommend early viewing to avoid disappointment.



- NO ONWARD CHAIN
- 1 BED GROUND FLOOR FLAT
- SOUTH FACING GARDEN
- CLOSE TO AMENITIES AND COMMUTER LINKS
- IDEAL INVESTMENT OPPORTUNITY
- IDEAL FIRST TIME BUY
- LONG LEASE