

# FLETCHERS

ESTATE AGENTS



## Fairlawn Avenue, W4

£525,000

A charming two bedroom flat on the first floor of this Victorian conversion. The property is recently decorated throughout and includes two bedrooms with built-in storage and a bright L-shaped kitchen/reception room.

Fairlawn Avenue is a popular central spot in W4 with Chiswick Park tube station on the doorstep, as well as easy access to the fantastic array of shops and restaurants on the Chiswick High Road and to the A4/M4.

- Two Bedrooms • First Floor Flat • Recently Decorated • Victorian Conversion • Built-In Storage • Chiswick Park •

## First Floor

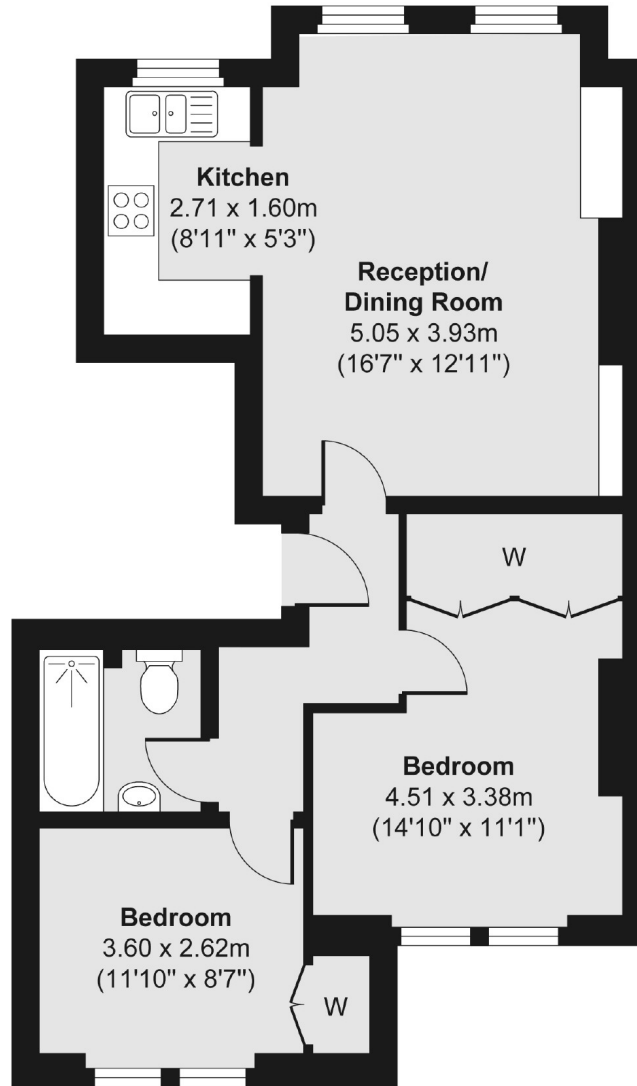

Total area (approx.) 56.57 sq. m (609 sq. ft)

Fletchers Chiswick Turnham Green Sales  
58 Turnham Green Terrace, London, W4 1QP  
020 8987 3000  
[chiswicksales@fletcherestates.com](mailto:chiswicksales@fletcherestates.com)

Energy Rating: C. We aim to make our particulars both accurate and reliable. However they are not guaranteed; nor do they form part of an offer or contract. If you require clarification on any points then please contact us, especially if you're traveling some distance to view. Please note that appliances and heating systems have not been tested and therefore no warranties can be given as to their good working order.