

TATES

Residential Sales & Lettings



Warwick House, Windsor Way, London W14 0UQ
£1,600 Per month

- Large one double bedroom
- Excellent condition
- 24hr portorage
- Brook Green
- Available now
- Gated development
- Furnished
- Energy Efficiency Rating Current Band: C

Warwick House, Windsor Way, W14

Approximate gross internal area
675 sq ft / 62.7 sq m

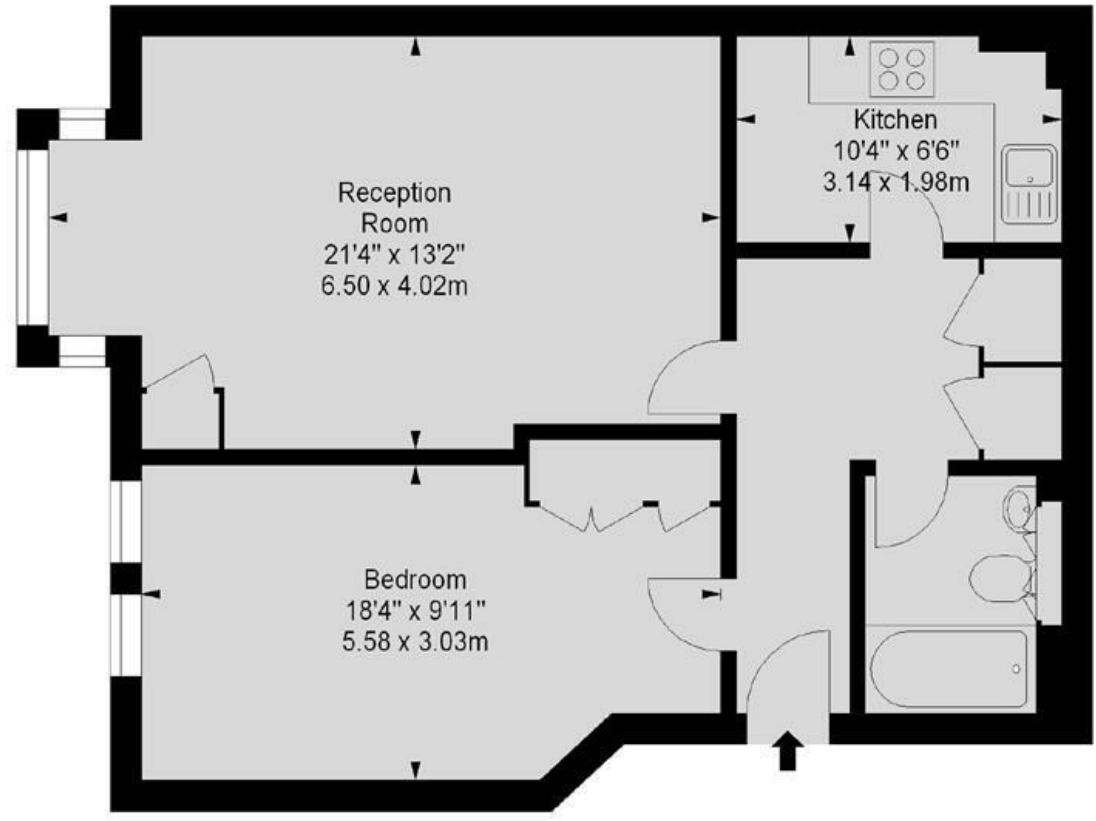

Second Floor

Illustration For Identification Purposes Only. Not To Scale
*Floorplan Drawn According To RICS Guidelines

Energy Efficiency Rating		Current	Potential
Very energy efficient - lower running costs			
(92 plus) A			
(81-91) B		77	80
(69-80) C			
(55-68) D			
(39-54) E			
(21-38) F			
(1-20) G			
Not energy efficient - higher running costs			
England & Wales		EU Directive 2002/91/EC	

Whilst these particulars are believed to be correct, no guarantee can be given for the measurements, appliances or services. It is our recommendation that all are tested. These are not intended to form part of any contract. **Tates** accept no responsibility for their accuracy.

135 Hammersmith Rd London W14 0QL.
T. 020 7602 6020 F. 020 7602 9522
mail@tatesestates.co.uk
tatesestates.co.uk

Tates (Agents) Ltd. Registered in England and Wales No. 2356337
Registered Office: 4th Floor Imperial House, 15 Kingsway London WC2B 6U

