



1 Queens Parade, BS1 5XJ

Brandon Steep



A spacious two double bedroom top floor flat positioned on a quiet back road yet within the heart of the city centre overlooking Brandon Hill.

The flat is perfect for first time buyers or an ideal investment. The layout works well with a good size living room which flows through to the kitchen at the rear and both bedrooms at the front which are comfortable doubles. The flat feels well balanced and homely.

- Spacious living in the heart of the city centre
- Quiet location at the foot of Brandon Hill
- 2 double bedrooms
- Gas central heating
- Tenure - Leasehold
- Circa 581 sqft



Accommodation

Lounge

A great size living space with plenty of room to create a dining area.

Kitchen

Semi open to the living area, the kitchen is fitted with ample cupboards for storage and provides good space.

The Bedrooms

Both bedrooms are comfortable doubles and ideal for anyone looking to flat share.

Bathroom

Fitted with a white three piece suite with a shower over the bath.

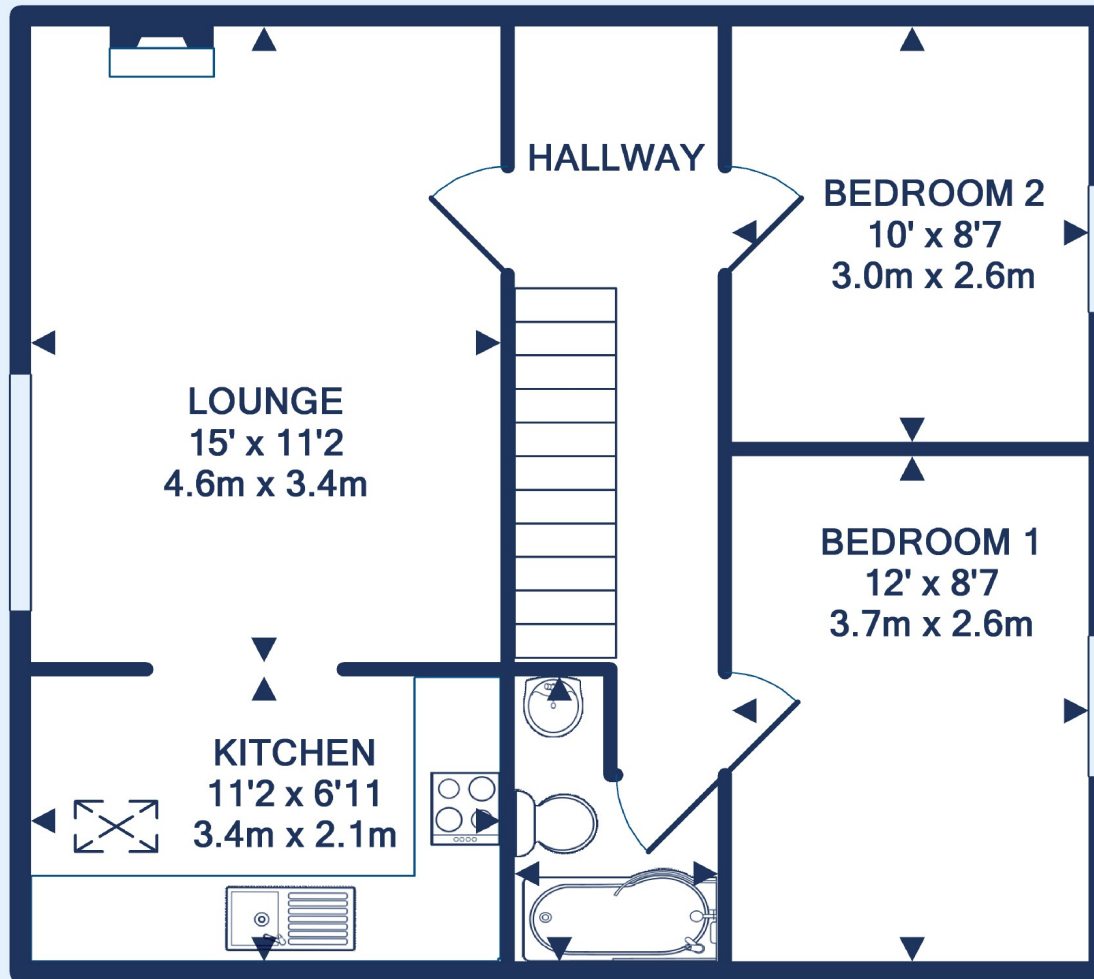



Brandon Steep - Offers in the region of £235,000

2 Bed Flat

References to the Tenure of a Property are based on information supplied by the Seller. The Agent has not had sight of the title documents. Lease details, service ground rent (where applicable) are given as a guide only and should be checked and confirmed by your solicitor prior to exchange of contracts.

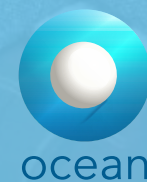

Clifton Branch

187 Whiteladies Road, Clifton, Bristol, BS8 2RY

Call: 0117 9466007

Mail: cliftonsales@oceanhome.co.uk

Search: www.oceanhome.co.uk