

SNELLERS

ESTATE AGENTS



Clevedon Road, TW1

£2,250 PCM

In a secure, gated riverside development, this spacious two double bedroom, two bathroom third floor flat has a large lounge with a Juliet balcony, a separate kitchen and a master bedroom with an en suite bathroom.

The Richmond Bridge development overlooks the river Thames and provides easy access to Richmond town centre for an array of shops and restaurants with St Margarets village in the opposite direction for a number of local shops and cafes.

- Gated Development • Two Bedrooms • Two Bathrooms •
- Concierge • Underground Parking • Great Location •

Third Floor

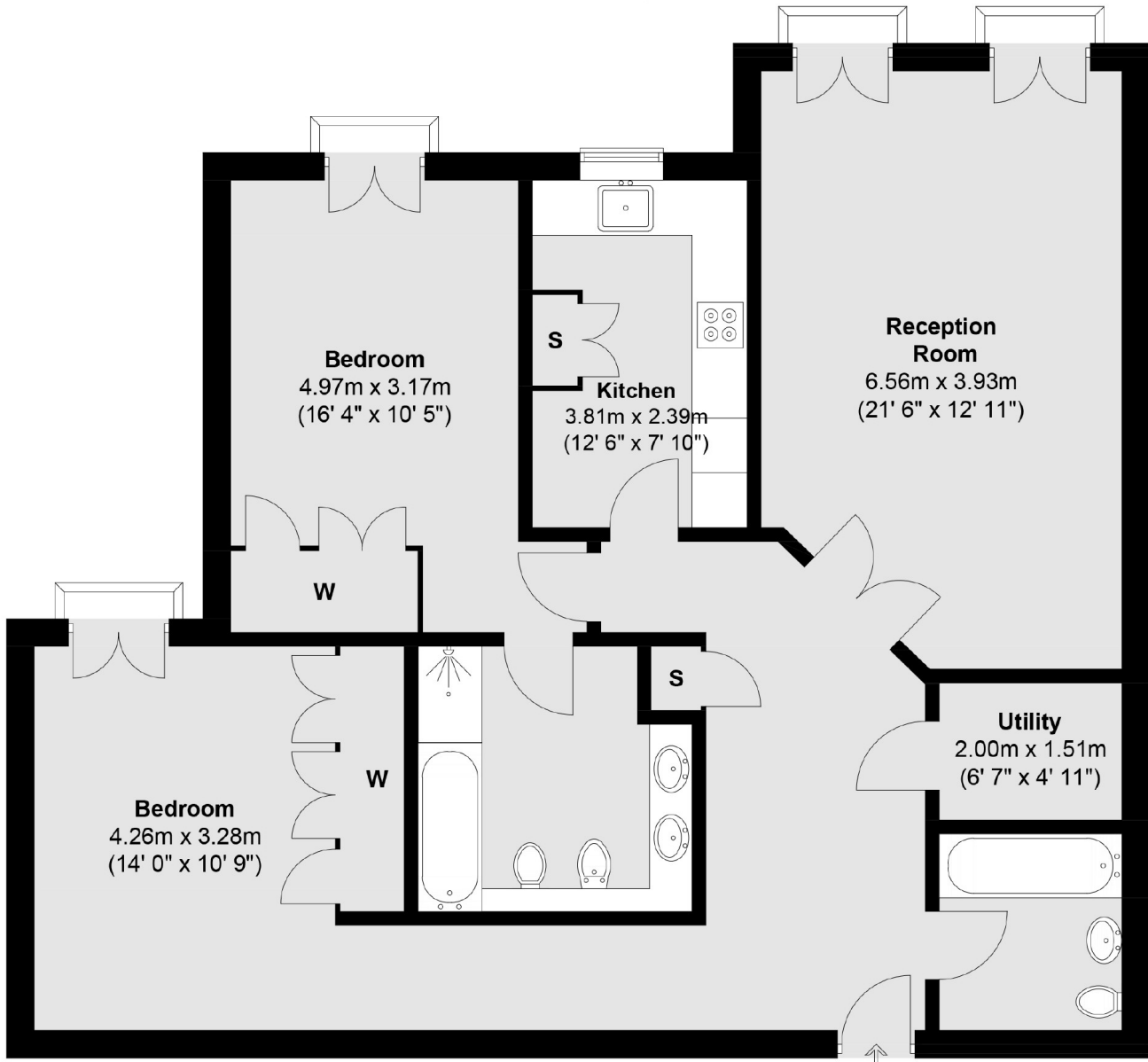

Total area (approx.) : 108.6 sq. m (1169 sq. ft)
Total balcony area (approx.) : 2.3 sq. m (25 sq. ft)

Snellers St. Margarets Lettings
36 Crown Road
St Margarets
TW1 3EH
020 8892 0700
stmargaretslettings@snellers.co.uk

Energy Rating: C We aim to make our particulars both accurate and reliable. However they are not guaranteed; nor do they form part of an offer or contract. If you require clarification on any points then please contact us, especially if you're traveling some distance to view. Please note that appliances and heating systems have not been tested and therefore no warranties can be given as to their good working order