

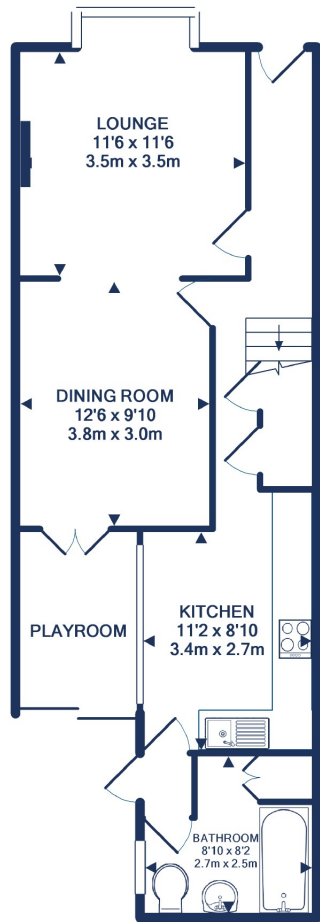

## Victoria Park - £385,000

3 bed terraced house  
7 Brendon Road, BS3 4PJ





GROUND FLOOR



1ST FLOOR

Made with Metropix ©2020



A beautifully presented mid-terrace home located on Brendon Road in Victoria Park. This property has a lounge, dining room, playroom, kitchen, downstairs bathroom, rear access, garden and 3 double bedrooms.

**Why you'll love it**  
This a good sized 3 double bedroom house in the city, with a larger than normal garden for the area and it gets plenty of sun.

**Outside**  
To the front of the property there is a small front garden with steps up to the door and space for bins & recycling. There is a good sized rear garden which is raised, it has a dining area, a glover lawn and a shed.

**Location**  
Situated on Brendon Road in BS3, this property has the benefit of being close to Victoria Park, St Mary Redcliffe Primary School and Victoria Park Primary School, Bristol Temple Meads and the City Centre. The shops, restaurants and amenities of North street and Wapping Wharf are within easy walking distance.

**We Think**  
We love the helpful friendly neighbours. Everything is a short walk away- The best park in Bristol is 4 minutes, train station 6 minutes and Bristol city centre is 18 minutes walk.



**Southville Office**

275 North Street, Southville, BRISTOL, BS3 1JN

Call: 0117 9231866

Mail: [southvillesales@oceanhome.co.uk](mailto:southvillesales@oceanhome.co.uk)

Search: [oceanhome.co.uk](http://oceanhome.co.uk)

References to the Tenure of a Property are based on information supplied by the Seller. The Agent has not had sight of the title documents. Lease details, service ground rent (where applicable) are given as a guide only and should be checked and confirmed by your solicitor prior to exchange of contracts.