



Wheatlands | HOUNSLOW | TW5 0SA

£314,950

This larger than average two bedroom flat comes on the market chain free and with a lease over 900 years. A fantastic buy for a first time buyer, situated on this sought after road and benefitting from a balcony area. The property consists of a good size lounge, a separate kitchen, a three piece bathroom suite, two large double bedrooms and a garage located in a block. Locally the property is within walking distance to local shops, schools and transport links. With so much to offer, viewings are highly recommended.

Tenure

Leasehold

Council Tax Band

C

Viewing Arrangements

Strictly by appointment

Contact Details

10 Central Parade

New Heston Road

Heston

Middlesex

TW5 0LH

020 8570 7258

heston@shawandcoestates.com

www.shawandcoestates.com

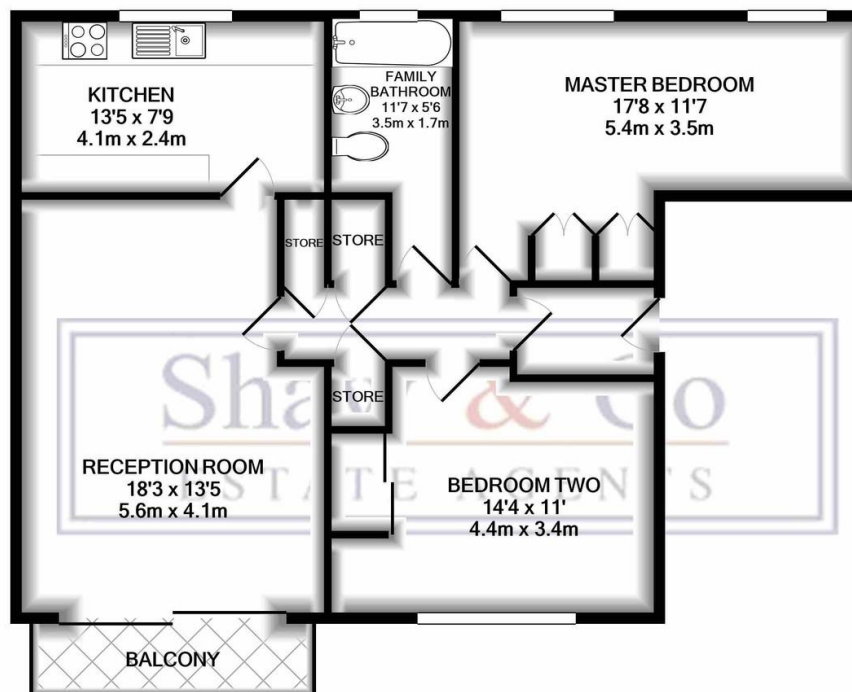

TOTAL APPROX. FLOOR AREA 791 SQ.FT. (73.5 SQ.M.)

Whilst every attempt has been made to ensure the accuracy of the floor plan contained here, measurements of doors, windows, rooms and any other items are approximate and no responsibility is taken for any error, omission, or mis-statement. This plan is for illustrative purposes only and should be used as such by any prospective purchaser. The services, systems and appliances shown have not been tested and no guarantee as to their operability or efficiency can be given
Made with Metropix ©2020

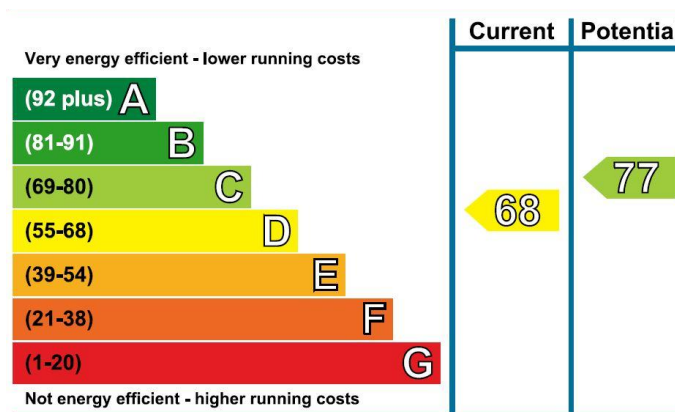

Agents Note: Whilst every care has been taken to prepare these particulars, they are for guidance purposes only. All measurements are approximate and for general guidance purposes only and whilst every care has been taken to ensure their accuracy, they should not be relied upon and potential buyers/tenants are advised to recheck the measurements