



**73 CECIL AVENUE, WARMSWORTH, DONCASTER,
DN4 9QP**

- **Warmsworth**
- **Mid-Terraced House**
- **Two Bedrooms**
- **Kitchen/Diner**
- **Attractive Rear Garden**
- **Garage**
- **No Onward Chain**
- **Great Commuter Links**
- **Ready To Move In**
- **Ideal First Home or Investment**

ASKING PRICE OF: £105,000



Being marketed with NO ONWARD CHAIN is this two bedroom, mid-terraced property in Warmsworth. Warmsworth has always been popular with buyers due to its fantastic commuting links. Whether it's in and out of Doncaster, Rotherham or anywhere along the A1/M18 corridor, Warmsworth is a great choice. This house would be ideally suited to a first time buyer or perhaps even an investor as this property does have a strong rental history. The accommodation on offer is over two floors and could perhaps be described as your quintessential two up, two down. You will find the lounge and kitchen/diner on the ground floor along with the two bedrooms and bathroom on the first floor. There is also an attractive rear garden and a garage to this property. Call the office today for further information and to book a viewing



GROUND FLOOR
387 sq.ft. (36.0 sq.m.) approx.

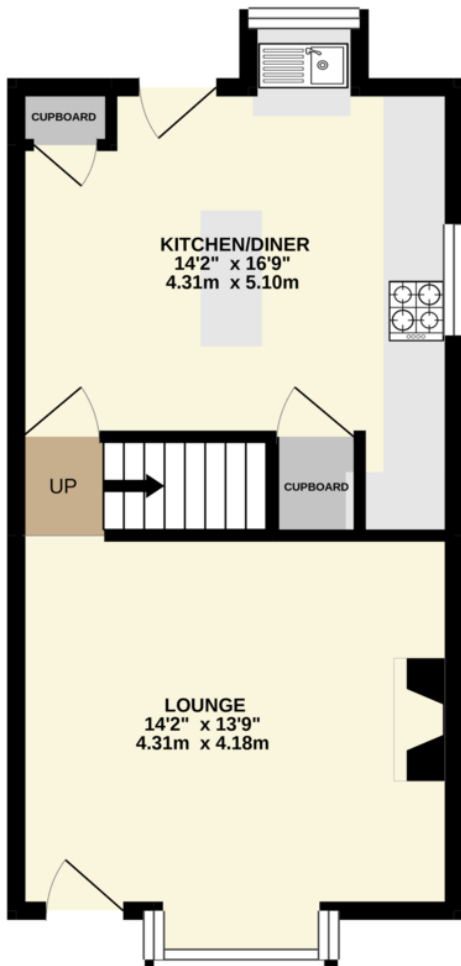

1ST FLOOR
372 sq.ft. (34.6 sq.m.) approx.

