

Chard

— Lettings —



Wetherby Gardens, SW5

£950 pw (£4,117 pcm)

This well presented two bedroom raised ground floor Victorian conversion is ideally located close to Gloucester Road and South Kensington with a beautiful communal garden square on your doorstep. The property has a large reception room perfect for entertaining.

Wetherby Gardens is well located for the shops and restaurants on Gloucester Road and Old Brompton Road. Gloucester Road station is nearby and you also have easy access to South Kensington and Knightsbridge.

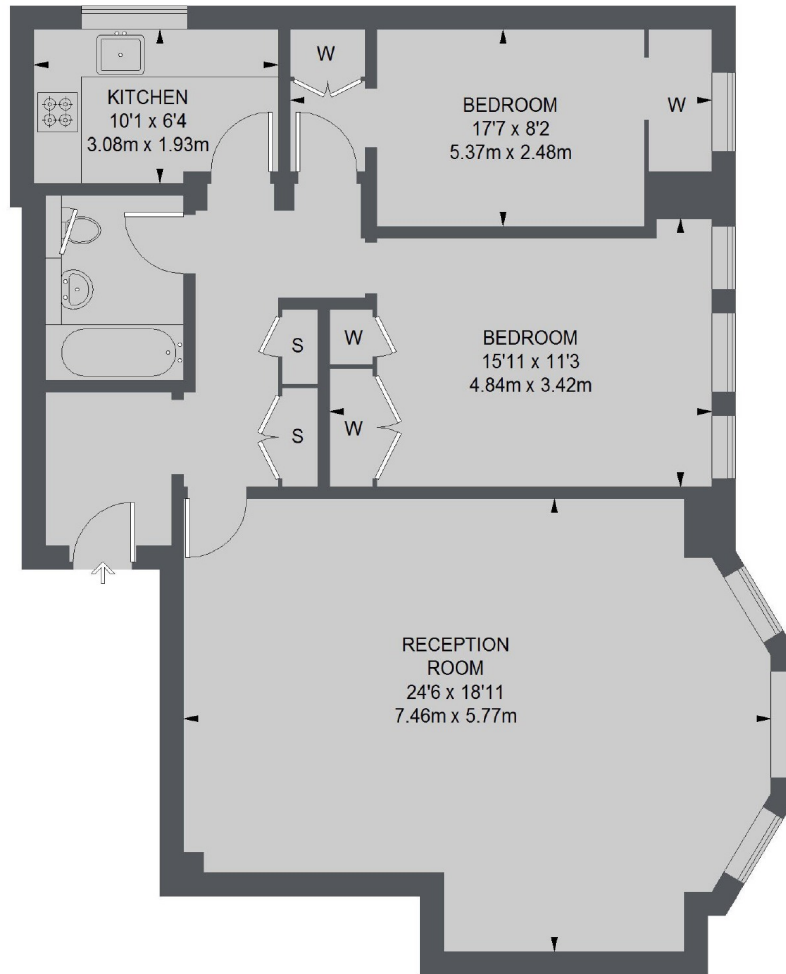

RAISED GROUND FLOOR

TOTAL APPROX. FLOOR AREA
958 SQ. FT. (89.0 SQ. M.)

Chard Fulham
5 Harwood Road,
London, SW6 4QP
020 7384 1400
fulhamlettings@chard.co.uk

Energy Rating: D. We aim to make our particulars both accurate and reliable. However they are not guaranteed; nor do they form part of an offer or contract. If you require clarification on any points then please contact us, especially if you're traveling some distance to view. Please note that appliances and heating systems have not been tested and therefore no warranties can be given as to their good working order.