



West Gate, W5

£450 pw (£1950 pcm)

This boutique warehouse conversion has been designed to the highest of standards, the property has two bedrooms, two bathrooms and underfloor heating.

Manhattan House is less than half a mile from Hanger Lane station (Central Line) and is within easy reach of the A40 for drivers.

- Brand New Apartments • Two Bedrooms • Two Bathrooms •
- Open-Plan Living • Under Floor Heating • Modern Kitchen •

First Floor

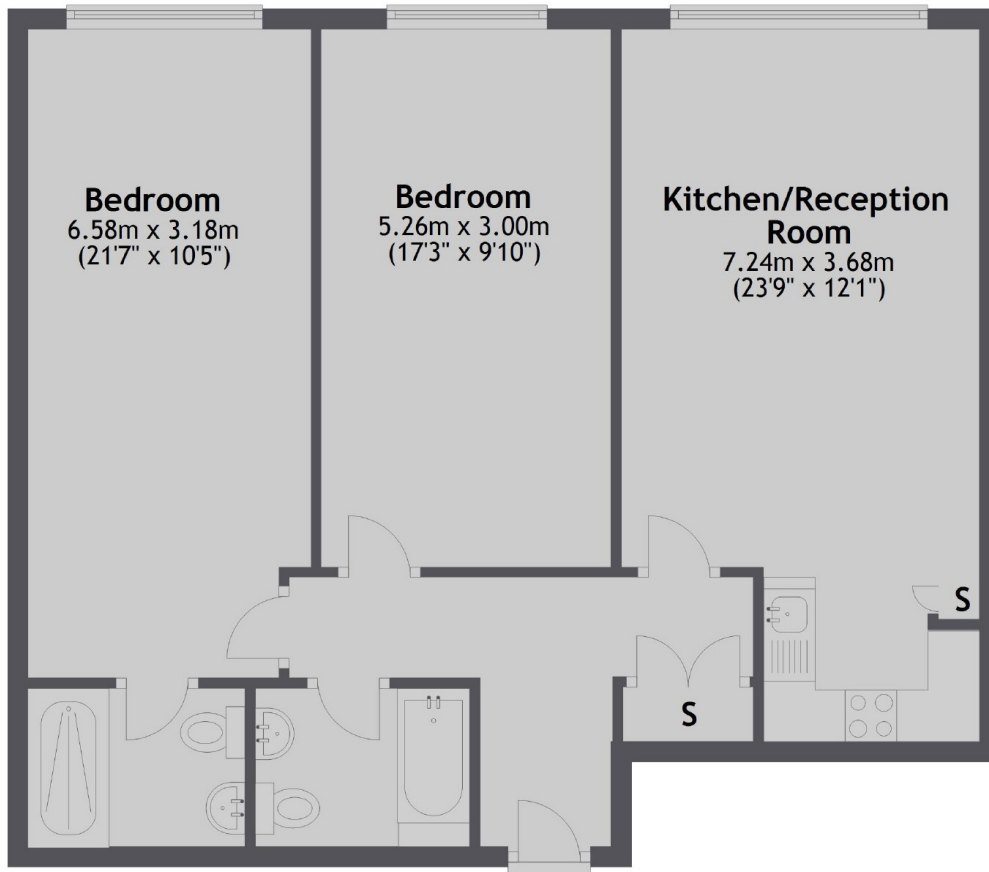

Robertson Smith & Kempson Ealing Lettings
1 The Broadway, London, W5
2NT
020 8840 7885
ealinglettings@robertsonsmithandkempson.co.uk

Energy Rating: B. We aim to make our particulars both accurate and reliable. However they are not guaranteed; nor do they form part of an offer or contract. If you require clarification on any points then please contact us, especially if you're traveling some distance to view. Please note that appliances and heating systems have not been tested and therefore no warranties can be given as to their good working order.