



LOVETT
Sales & Lettings

Guide Price

£220,000



47 William Drive, Eynesbury, St. Neots, PE19 2RF

- THREE BEDROOM END OF TERRACE
- REFURBISHED THROUGHOUT
- REFITTED KITCHEN AND BATHROOM
- EASY ACCESS TO A428 & A1
- CLOSE TO LEISURE FACILITIES
- GARAGE TO REAR

Full Description

**** WE EXPECT THE PROPERTY TO SELL TO A BUYER LOOKING IN THE £220,000 - £230,000 RANGE. BEST OFFERS ARE INVITED ****

A REFURBISHED three bedroom end of terrace family home WITHIN WALKING DISTANCE TO PRIMARY AND SECONDARY SCHOOLS as well as being within EASY REACH OF A428 & A1. The property is also conveniently located near local LEISURE FACILITIES including gym, indoor swimming pool, indoor/outdoor sports pitches and squash courts. The accommodation comprises lounge/diner and REFITTED KITCHEN on the ground floor with three bedrooms and a REFITTED BATHROOM on the first floor. Gas radiator heating. UPVC windows and doors. Enclosed corner plot garden. GARAGE TO REAR. No forward chain. Viewing highly recommended!

ENTRANCE HALL

UPVC entrance door leading to entrance hall. Stairs to first floor. Door leading to lounge / dining room.

LOUNGE/DINER

23' 4" x 11' 4" (7.11m x 3.45m)

UPVC bay window to front. UPVC French doors to rear garden. TV and telephone point. Radiator. Wood flooring. Cupboard under stairs. Door to kitchen.

KITCHEN

10' 10" x 6' 4" (3.3m x 1.93m)

Refitted kitchen comprising grey gloss work surfaces with complimentary work surfaces. Wall mounted cupboards. One and a half bowl sink with mixer tap and tiled splash backs. Built in electric oven and four ring hob with extractor fan over. Plumbing for washing machine. Cupboard housing gas boiler. Radiator. Tiled floor. UPVC windows fro rear.

LANDING

Access to loft space. Built in storage cupboard. Doors to bedrooms and bathroom.

BEDROOM ONE

12' 2" x 8' 7" (3.71m x 2.62m)

UPVC window to front. Radiator. Laminate floor.

BEDROOM TWO

10' 10" x 8' 7" (3.3m x 2.62m)

UPVC window to rear. Radiator.



BEDROOM THREE

6' 8" x 5' 6" (2.03m x 1.68m)

UPVC window to front. Radiator. Built in cupboard.



BATHROOM

Three piece suite comprising low level WC, pedestal wash hand basin and panelled bath with shower over and glass shower screen. Tiled splash backs. Radiator. Extractor fan. UPVC window to rear.



REAR GARDEN

Private enclosed rear garden mainly laid to shingle. Patio area. Outside water supply. Gated access to side. Outside light. Door to garage.



GARAGE

Single garage to rear with up and over door. Personal door to garden.



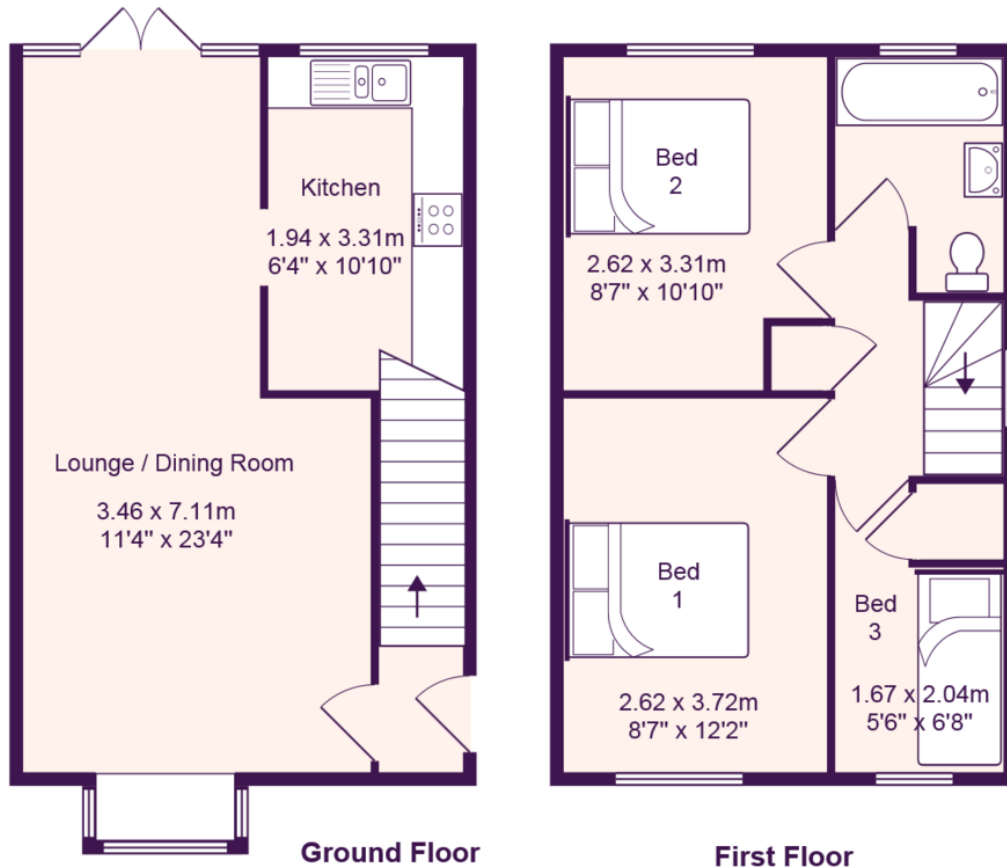

Total Area: 63.2 m² ... 680 ft²

All measurements are approximate and for display purposes only

EPC GRAPH
%epcGraph_c_1_250%