



## Hurlingham Business Park,

£1,700 pw (£7,366 pcm)

Short Let - This two bedroom two bathroom ground floor modern conversion is beautifully presented throughout and has a bright open plan living area, a modern integrated kitchen with all appliances, two spacious double bedrooms, one master with en-suite shower room and a fully tiled bathroom.

This property is located off Sullivan Road, with good access to local amenities on Wandsworth Bridge Road, Parsons Green and on Fulham Broadway. South Park and Hurlingham Park are close by and you have a variety of bus routes leading into Chelsea and the city.

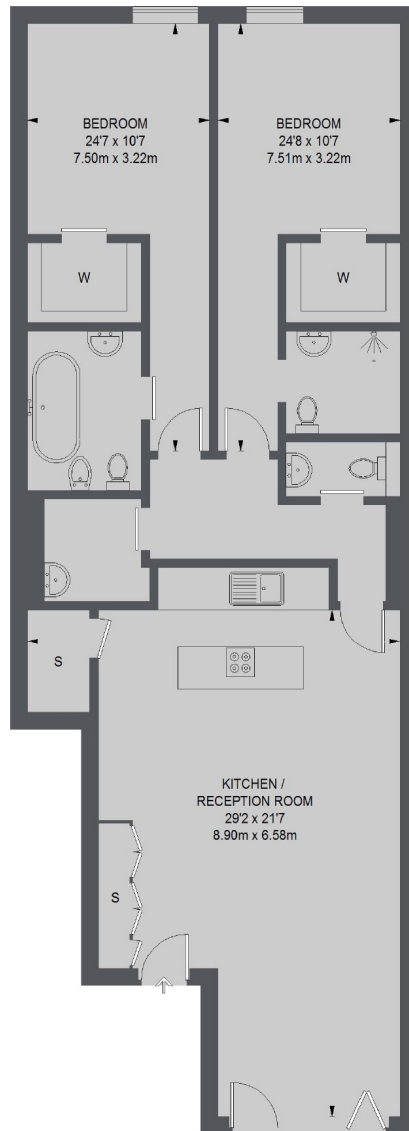

TOTAL APPROX. FLOOR AREA 1207 SQ. FT. (112.17 SQ. M.)

Chard Fulham  
5 Harwood Road,  
London, SW6 4QP  
020 7384 1400  
fulhamlettings@chard.co.uk

Energy Rating: . We aim to make our particulars both accurate and reliable. However they are not guaranteed; nor do they form part of an offer or contract. If you require clarification on any points then please contact us, especially if you're traveling some distance to view. Please note that appliances and heating systems have not been tested and therefore no warranties can be given as to their good working order.