



26 The Butts
Potterne, SN10 5LR

STRAKERS

26 The Butts, Potterne, SN10 5LR

Charming semi-detached cottage presented to a high standard with wonderful gardens and plenty of period charm

- Semi-detached Cottage
- Impressive Landscaped Gardens
- Two Bedrooms
- Spacious Living Room
- Well Appointed Kitchen
- Useful Utility Room
- Double Glazing
- Oil fired Heating

Asking Price £185,000



Description

Very pretty semi-detached cottage pleasantly located in an elevated position within this highly sought after village. The delightfully presented and well proportioned accommodation comprises two light and airy bedrooms with period features including wrought iron fireplaces, a spacious and smartly appointed family bathroom, living room with feature fireplace, fitted kitchen / breakfast room and a useful utility / boot room. Externally there are beautifully maintained gardens to both front and rear with a wonderful paved patio area and well stocked borders enclosed by timber fencing. The property benefits from double glazing and oil-fired central heating whilst being ideally located to enjoy countryside walks and the myriad of activities and amenities offered by this vibrant village.

Situation

The village of Potterne has a thriving community and provides a school, public house, church, village hall, newsagents/village shop and a post office. The historic market town of Devizes is approximately two miles to the north offering a more comprehensive range of shopping, transport and leisure facilities, a cinema, museum and thriving weekly market. The major centres of Bath, Chippenham, Salisbury, Swindon and Marlborough are all within a 25 mile radius.

Property Information

Tenure: Freehold

Local Authority: Wiltshire Council

Council Tax Band: B

Energy Performance Rating: D

Mains electricity, water and drainage connected.

Oil fired central heating



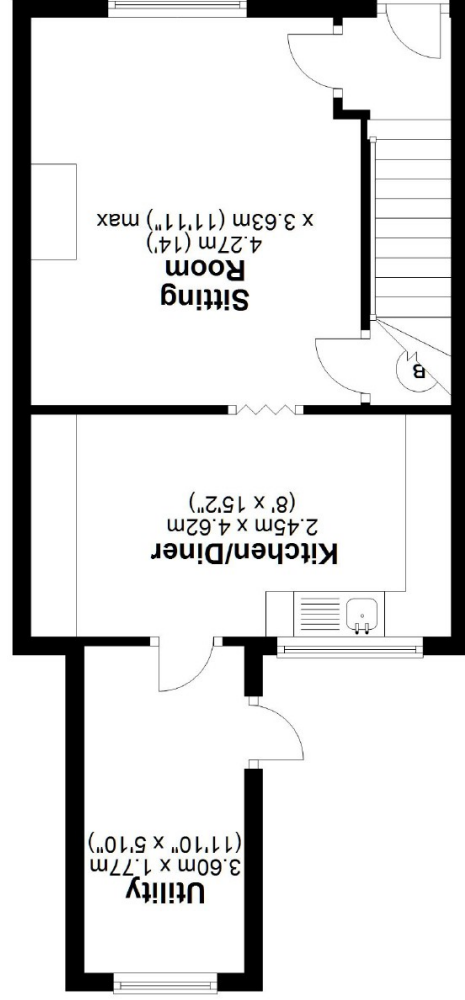

Ground Floor
Approx. 38.0 sq. metres (409.5 sq. feet)

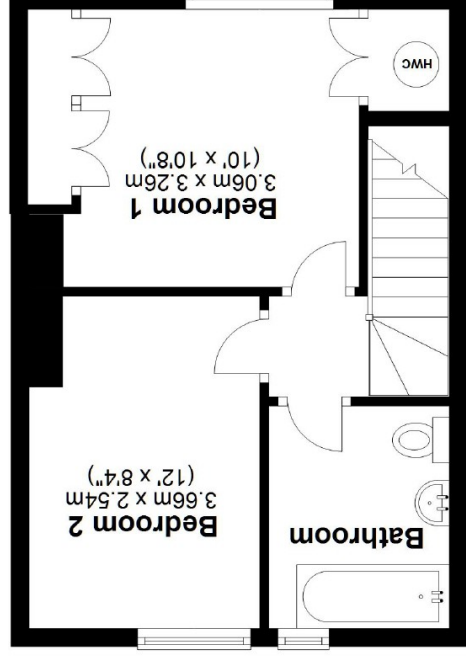

First Floor
Approx. 31.5 sq. metres (338.7 sq. feet)

Total area: approx. 69.5 sq. metres (748.2 sq. feet)

Floorplan may not be exactly to scale but is for illustrative purposes only
Plan produced using PlanUp.