



1 Hazel Brook Gardens, BS10 7FL

Cribbs Causeway



A show home condition, three bedroom end terrace of only three properties. Brilliantly situated just off Passage Road, within walking distance of The Mall, Cribbs Causeway and with bus links to Southmead Hospital and other amenities.

Upon entering this contemporary home, you are welcomed by a spacious hallway leading into a kitchen/diner. The remainder of the ground floor provides access to a w/c, integral garage and a private landscaped garden with decked and paved area for outside entertaining. There is off road parking for two cars.

Upstairs to the first floor you will find the master bedroom with en-suite, large lounge and further on the second floor there is further 2 bedrooms, and a family bathroom.



Accommodation

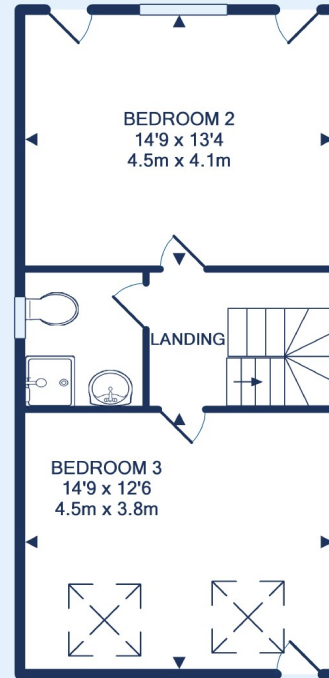
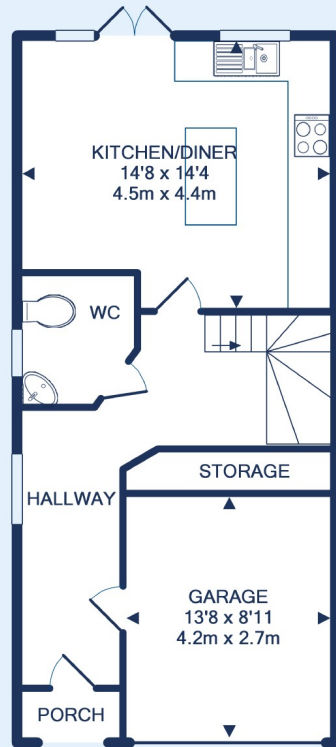



Cribbs Causeway - Guide price £325,000

3 Bed End of terrace house

References to the Tenure of a Property are based on information supplied by the Seller. The Agent has not had sight of the title documents. Lease details, service ground rent (where applicable) are given as a guide only and should be checked and confirmed by your solicitor prior to exchange of contracts.



Westbury on Trym Branch
73 Westbury Hill, Westbury-on-Trym, Bristol, BS9 3AD

Call: 0117 9621973

Mail: westburysales@oceanhome.co.uk

Search: www.oceanhome.co.uk