



Shirehampton - £210,000

3 bed semi-detached house

96 Springfield Avenue, BS11 9TQ



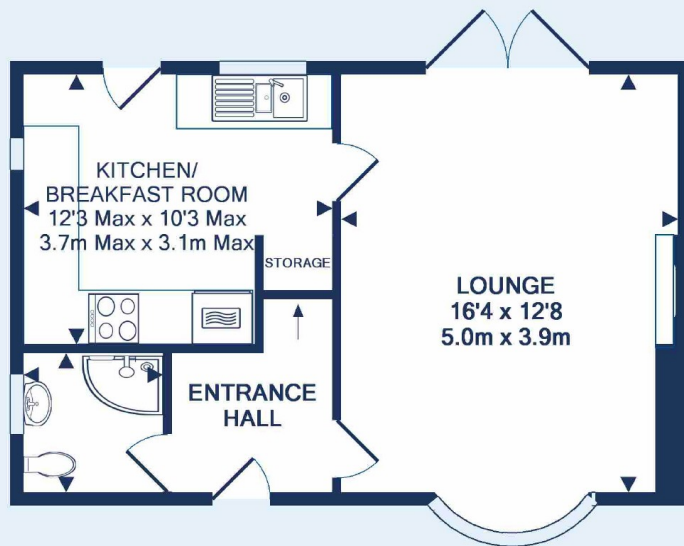

GROUND FLOOR
APPROX. FLOOR
AREA 382 SQ.FT.
(35.5 SQ.M.)



1ST FLOOR
APPROX. FLOOR
AREA 382 SQ.FT.
(35.5 SQ.M.)

TOTAL APPROX. FLOOR AREA 764 SQ.FT. (71.0 SQ.M.)
Made with Metropix ©2018



A fantastic and well priced semi-detached home in a very sought after location in Shirehampton, Springfield Avenue is likely to have taken its name from a field and a house (Springfield House) that was built there in 1911 which still stands to this day. This superb home has been cared for by the current owner who currently presents accommodation consisting entrance hall, lounge, an impressive kitchen breakfast room, downstairs shower room, landing & three bedrooms. Externally there is a rear garden mainly laid to lawn, front garden, off street parking and side access.



Shirehampton Branch

14-16 High Street, Shirehampton, Bristol,
BS11 0DP

Call: 0117 9380611

Mail:

Search: oceanhome.co.uk

References to the Tenure of a Property are based on information supplied by the Seller. The Agent has not had sight of the title documents. Lease details, service ground rent (where applicable) are given as a guide only and should be checked and confirmed by your solicitor prior to exchange of contracts.