



**Horfield - £290,000**

2 bed terraced house

24 Boston Road, BS7 0HA



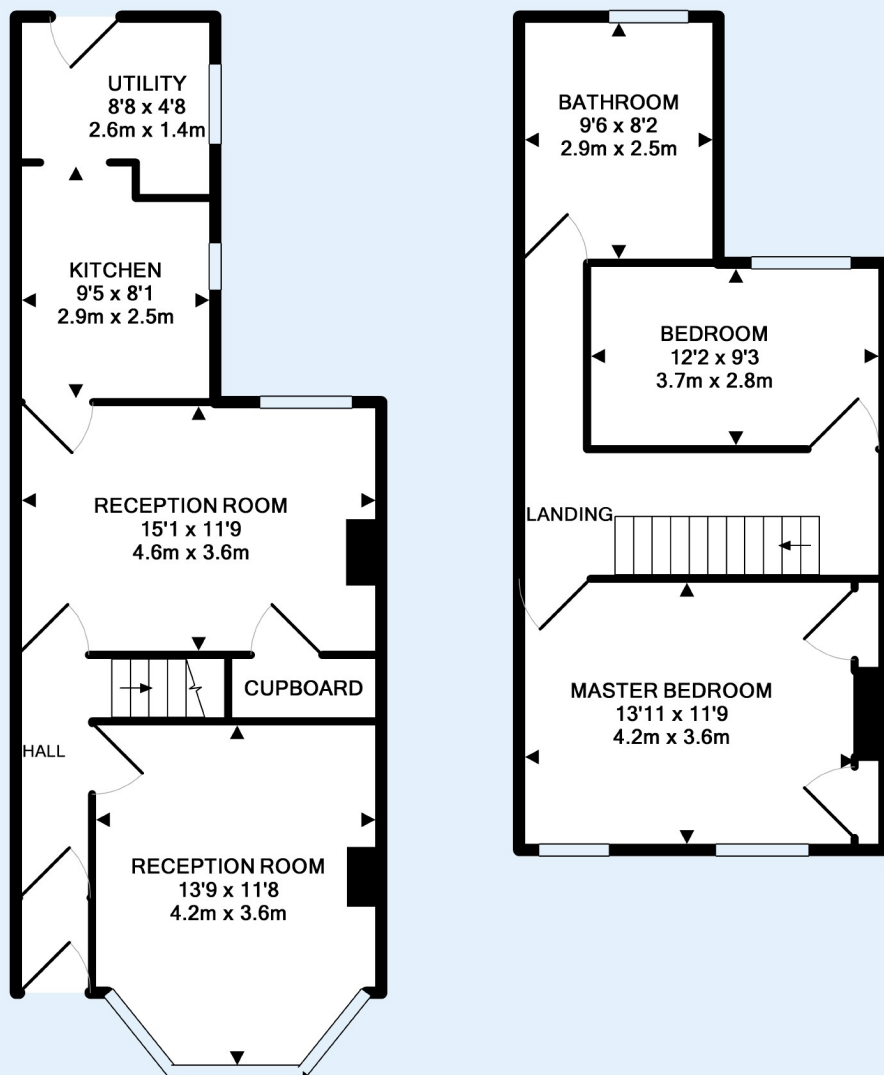

Made with Metropix ©2018



A charming 2 bedroom mid terrace home located on Boston Road, Horfield. Just off Gloucester Road, this quietly placed period property, perfect for first time buyers looking to add their own stamp. Conveniently located close to the renowned Inn on the green, Horfield Leisure Centre and Southmead Hospital, this property is offered with no onward chain.

In brief, accommodation includes 2 double bedrooms with a large bathroom suite. Downstairs hosting 2 separate reception rooms, kitchen and a utility room with access through to a low maintenance south facing garden. This property benefits from double glazing and gas central heating. Available to view from the 29th March by appointment only. 0117 904 4000



#### Filton Branch

8 Gloucester Road North, Filton, Bristol, BS7 0SF

Call: 0117 9044000

Mail: [filtionsales@oceanhome.co.uk](mailto:filtionsales@oceanhome.co.uk)

Search: [oceanhome.co.uk](http://oceanhome.co.uk)

References to the Tenure of a Property are based on information supplied by the Seller. The Agent has not had sight of the title documents. Lease details, service ground rent (where applicable) are given as a guide only and should be checked and confirmed by your solicitor prior to exchange of contracts.