



Kingsley Road, Palmers Green, London, N13
£1,400 Per Calendar Month

Anthony Webb
ESTATE AGENTS

Kingsley Road, Palmers Green, London, N13

BEAUTIFUL GROUND FLOOR GARDEN FLAT CLOSE TO SHOPS/STATION. A well presented two bedroom Edwardian converted flat located in a most popular residential turning off Hazelwood Lane. The property consists of a spacious living room with bay window, wood floor and feature fireplace, a modern kitchen/diner with French doors to own 75ft approx rear garden, a modern bathroom, gas central heating, new hallway carpet, one double bedroom with wood floor and French doors to garden and a good size single bedroom. The property is offered part furnished and will available from 20th of November.

- Two bedrooms
- Ground floor flat
- Spacious living room
- Modern kitchen/diner
- Modern bathroom
- Own rear garden
- Hazelwood school catchment
- Close to shops/station





Kingsley Road
Palmers Green
London
N13 5PL

Tenure:
Gross Internal Area: 603.00 sq ft

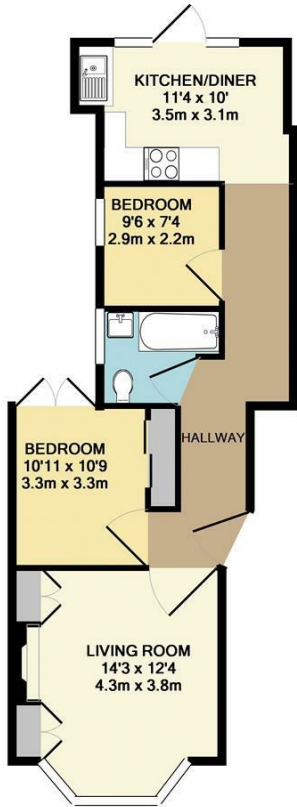
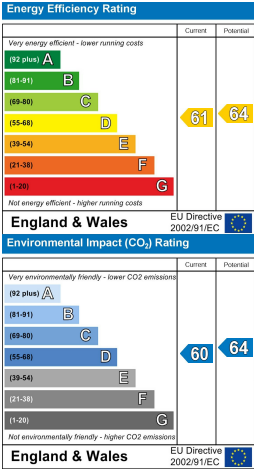

TOTAL APPROX. FLOOR AREA 603 SQ.FT. (56.0 SQ.M.)

Whilst every attempt has been made to ensure the accuracy of the floor plan contained here, measurements of doors, windows, rooms and any other items are approximate and no responsibility is taken for any error, omission, or mis-statement. This plan is for illustrative purposes only and should be used as such by any prospective purchaser. The services, systems and appliances shown have not been tested and no guarantee as to their operability or efficiency can be given

Made with Metropix ©2017

Property particulars as supplied by Anthony Webb Estate Agents are set out as a general outline in accordance with the Property Misdescriptions Act (1991) only for the guidance of intending purchasers of lessees, and do not constitute any part of an offer or contract. Details are given without any responsibility, and any intending purchasers, lessees or third parties should not rely on them as inspection or otherwise as to the correctness of each of them. We have not carried out a structural survey and the services, appliances and specific fittings have not been tested. All photographs, measurements, floor plans and distances referred to are given as a guide only and should not be relied upon for the purchase of carpets or any other fixtures statements or representations of fact, but must satisfy themselves by or of fittings, gardens, roof terraces, balconies and communal gardens as well as tenure and lease details cannot have their accuracy guaranteed for intending purchasers. Lease details, service ground rent (where applicable) are given as a guide only and should be checked and confirmed by your solicitor prior to exchange of contracts. no person in the employment of Anthony Webb has any authority to make any representation or warranty whatever in relation to this property.

348 Green Lanes, Palmers Green, London N13 5TJ
020 8882 7888
palmersgreen@anthonywebb.co.uk
anthonywebb.co.uk

